

# Frame Installation *Non Anchor Application*

**TOOLS NEEDED:** Tape measure, level, phillips screwdriver, pencil. For masonry applications a 5/32 drill bit and masonry drill.

**WHAT'S IN THE BOX:** For each AMR frame there will be (4) frame sticks labeled **TOP**, **BOTTOM**, **LEFT**, **RIGHT**, (4) corner clips, Wall-Dog screws for drywall applications and Tapcon screws (blue) for masonry applications.

**STEP 1:** Slide a corner clip into the left and right side of the **TOP** frame stick. Tighten the screws against the metal backplate of the frame.

**STEP 2:** Using a level, draw a line where you would like the top stick to be. Using a screwdriver, attach the **TOP** frame stick to the wall using the screws.

**STEP 3:** Install the **LEFT**, **RIGHT**, **BOTTOM** sticks using only the corner clips. Do not screw it to the wall in this step.

**STEP 4:** Using a level, make sure the frame is plumb. Adjust corner clips if needed.

**STEP 5:** Insert the remaining screws.

*Not all steps have corresponding photos as reference.*

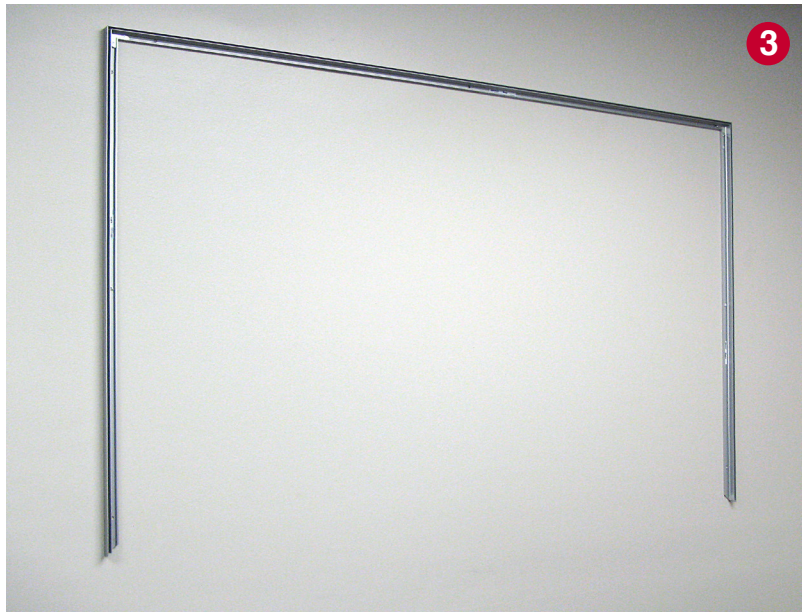
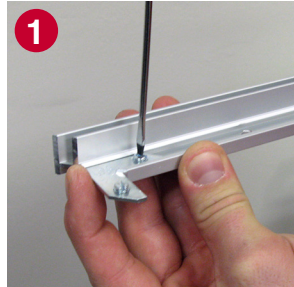

*Tip: Adjust corner clips if needed to achieve plumb corners before putting in screws.*

**iM**BRANDED



# Fabric Insert Installation

**TOOLS NEEDED:** None

**STEP 1:** Begin by inserting the **RED**-edged, rubber strip (along the edge of the fabric) into the groove at the four corners of the frame. Make sure the rubber strip edges come together for a smooth corner making sure the fabric corner is tucked in.

**STEP 2:** Insert the middle of each of the four sides of the fabric into the grooves and work your way out to the corners on each side. Be careful not to over-stretch the fabric when placing it into the grooves of the frame. Over-stretching the fabric will prevent the graphic from fitting correctly into the frame.

**NOTE:** The graphic fabric is designed to stretch to a taught, smooth fit. Your fabric will first appear to be too short to fit into the **BOTTOM** frame groove. With one hand, pull the fabric just beyond the edge of the frame. With your other hand, gently insert the fabric edge into the groove.

**STEP 3:** After you fit the last portion of the graphic fabric into the end of the groove, slide your thumb back along the edge of the frame to smooth away any bumps that may have resulted. If wrinkles occur, take out sections and repeat Step 2 until you achieve a smooth finish.

**Cleaning:** Fabric may be machine washed in cold water and line dried.

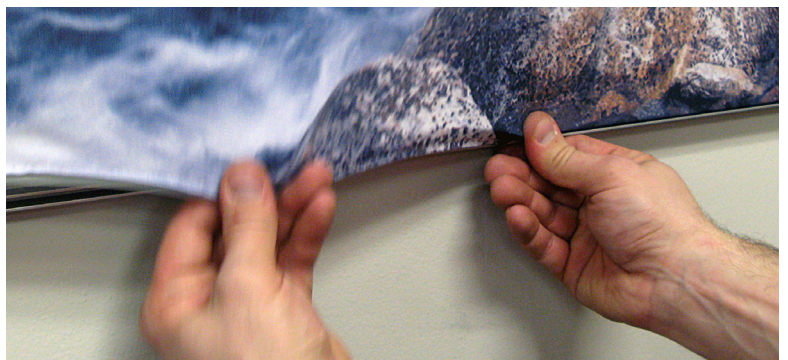
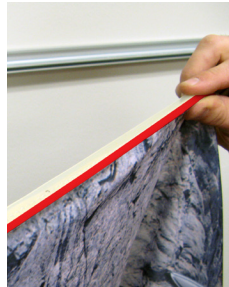
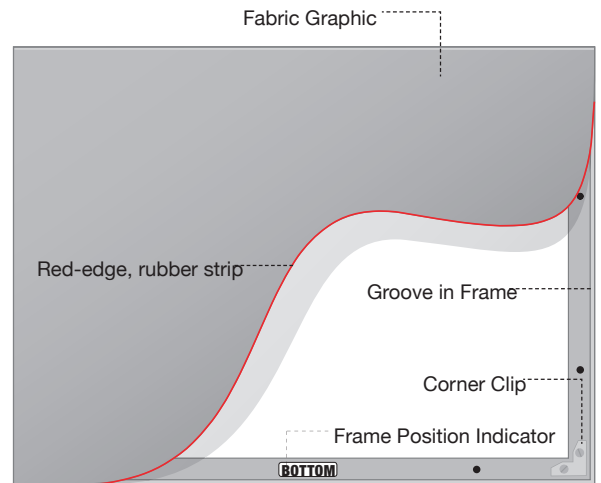

**IMBRANDED**

imbranded.com

*Frame installation on reverse side*